

3 Station System Specification Layout

Rev. # 2/18/05

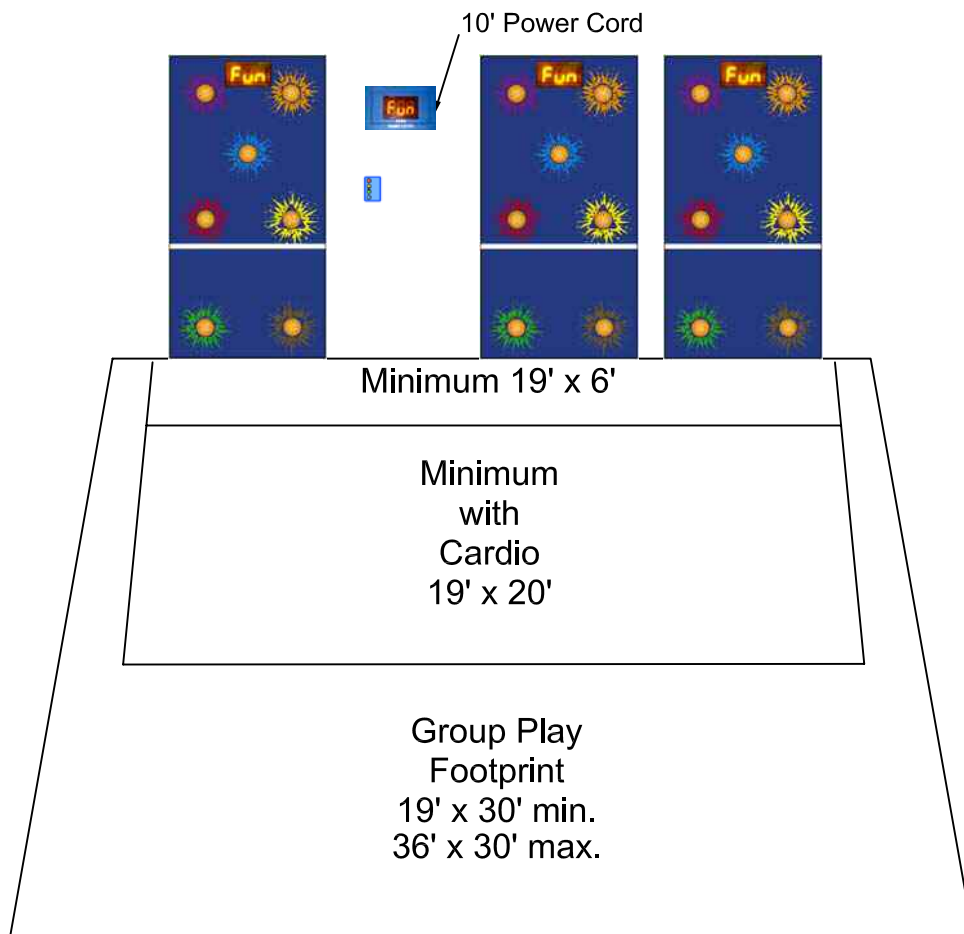
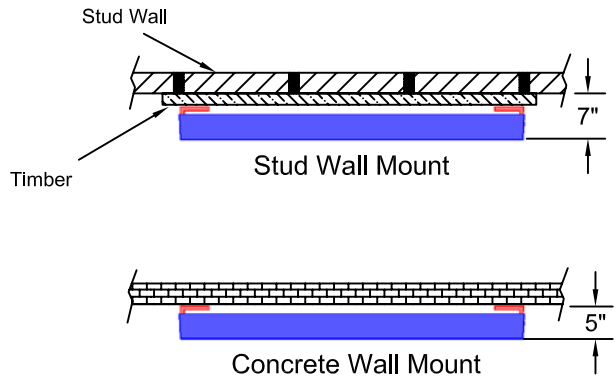
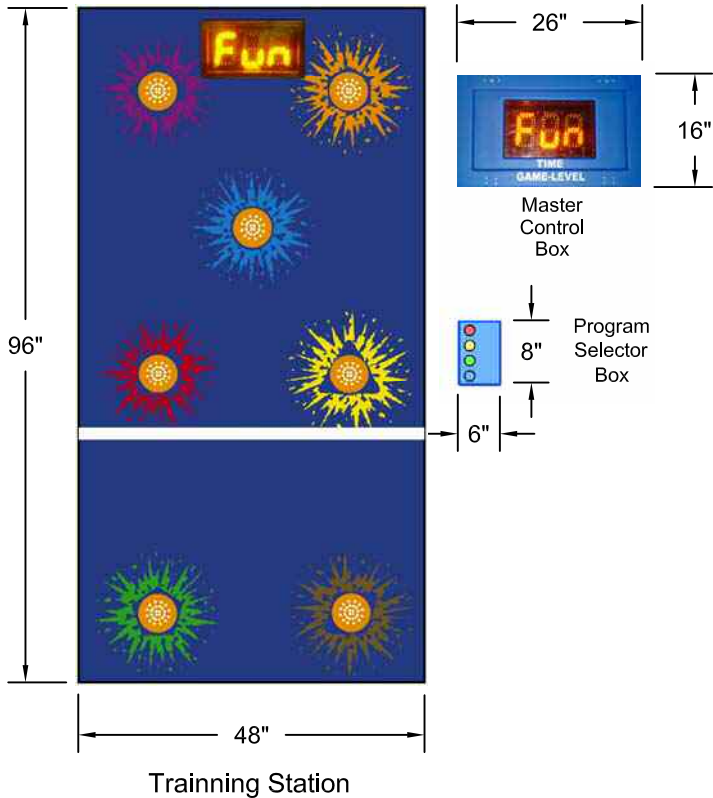

Notes:

- Minimum distance between stations: 2'
- Maximum distance between stations: 10'

Product Specification Sheet



PRODUCT NAME: **Sportwall Training Stations - 3 Station System**
 PART NUMBER: **4-6030**

Rev # 3/10/05

SPECIFICATIONS		Quantity
Footprint - Training Station	96"H x 48"W x 5"D	3
Weight - Training Station	90 lbs	
Color	Blue with Splash Targets	
Footprint - Master Control Box	16"H x 26"W x 4"D	1
Weight – Master Control Box	15 lbs	
Footprint - Program Selector Box	9"H x 6"W x 3"D	1
Weight - Program Selector Box	3 lbs	
Min. play footprint – non Cardio	19' wide x 6' deep	
Min. play footprint – with Cardio	19' wide x 20' deep	
Group play footprint:	19' wide x 30' deep min., 36' wide x 30' deep max.	
System power requirements	100-240 V, 3 amps, receptical	1
System fill material per Station	sand - 225 lbs	3
Wall preparation required	YES (for stud wall installations)	
Outdoor adapter kit	YES (available as added option)	
Floor requirements	Standard approved gym or sport floor	
Training group size	Up to:	18
Site survey required	YES	

FEATURES		
Scoreboard	YES	3
Electronic Targets	YES	21
Independent Time clock	YES	1
Speakers	YES	2
Pre-programmed Audio	YES (instructions, game music, fanfare)	
Auto Restart Mode	YES	
Instruction Manual	YES	1
Quick Start Guides	YES	2
Quick Start Posters	YES	2
Individual Workout Charts	YES	3
Remote Control	YES	2
Wall Mounted Control	YES	1
Ball Kit per Station	YES	3
(2 noodles, 2 balls each size 5", 7", 8.5" & 6 juggle balls)		

PROGRAMS & CURRICULUM		
Pre-programmed Games / Levels	YES	20
Curriculum Grades 1 - 6	YES	
Curriculum Youth Fitness	YES	
30 minute Instructor Led Workout Guide	YES	
Individual Workouts - Youth	YES	